

南雄市G323线珠玑镇梅岭村路段A地块
2800.6-38534.7

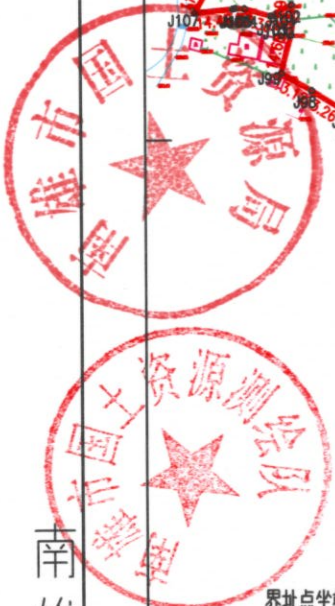

南雄市国土资源局测绘队

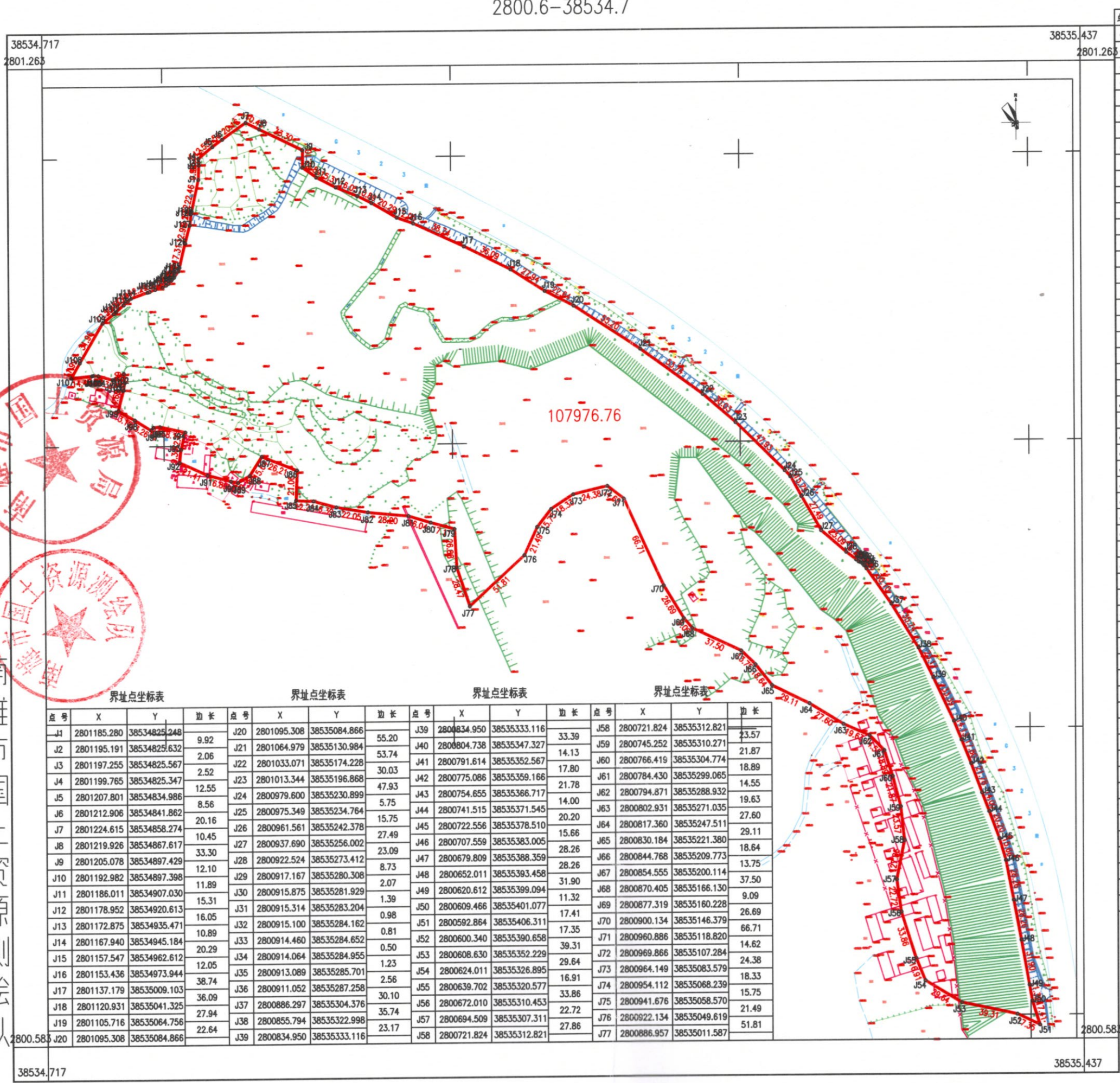

界址点坐标表

点号	X	Y	边长
J1	2801185.280	38534825.248	9.92
J2	2801195.191	38534825.632	2.06
J3	2801197.255	38534825.567	2.52
J4	2801199.765	38534825.347	12.55
J5	2801207.801	38534834.986	8.56
J6	2801212.906	38534841.862	20.16
J7	2801224.615	38534858.274	10.45
J8	2801219.926	38534867.617	33.30
J9	2801205.078	38534897.429	12.10
J10	2801192.982	38534897.398	11.89
J11	2801186.011	38534907.030	15.31
J12	2801178.952	38534920.613	16.05
J13	2801172.875	38534935.471	10.89
J14	2801167.940	38534945.184	20.29
J15	2801157.547	38534962.612	12.05
J16	2801153.436	38534973.944	38.74
J17	2801137.179	38535009.103	36.09
J18	2801120.931	38535041.325	27.94
J19	2801105.716	38535064.756	22.64
J20	2801095.308	38535084.866	

界址点坐标表

点号	X	Y	边长
J20	2801095.308	38535084.866	55.20
J21	2801064.979	38535130.984	53.74
J22	2801033.071	38535174.228	30.03
J23	2801013.344	38535196.868	47.93
J24	2800979.600	38535230.899	5.75
J25	2800975.349	38535234.764	15.75
J26	2800961.561	38535242.378	27.49
J27	2800937.690	38535256.002	23.09
J28	2800922.524	38535273.412	8.73
J29	2800917.167	38535280.308	2.07
J30	2800915.875	38535281.929	1.39
J31	2800915.314	38535283.204	0.98
J32	2800915.100	38535284.162	0.81
J33	2800914.460	38535284.652	0.50
J34	2800914.064	38535284.955	1.23
J35	2800913.089	38535285.701	2.56
J36	2800911.052	38535287.258	30.10
J37	2800886.297	38535304.376	35.74
J38	2800855.794	38535322.998	23.17
J39	2800834.950	38535333.116	

界址点坐标表

点号	X	Y	边长
J39	2800834.950	38535333.116	33.39
J40	2800804.738	38535347.327	14.13
J41	2800791.614	38535352.567	17.80
J42	2800775.086	38535359.166	21.78
J43	2800754.655	38535366.717	14.00
J44	2800741.515	38535371.545	20.20
J45	2800722.556	38535378.510	15.66
J46	2800707.559	38535383.005	28.26
J47	2800679.809	38535388.359	28.26
J48	2800652.011	38535393.458	31.90
J49	2800620.612	38535399.094	11.32
J50	2800609.466	38535401.077	17.41
J51	2800592.864	38535406.311	17.35
J52	2800600.340	38535390.658	39.31
J53	2800608.630	38535352.229	29.64
J54	2800624.011	38535326.895	16.91
J55	2800639.702	38535320.577	33.86
J56	2800672.010	38535310.453	22.72
J57	2800694.509	38535307.311	27.86
J58	2800721.824	38535312.821	

界址点坐标表

点号	X	Y	边长
J58	2800721.824	38535312.821	23.57
J59	2800745.252	38535310.271	21.87
J60	2800766.419	38535304.774	18.89
J61	2800784.430	38535299.065	14.55
J62	2800794.871	38535288.932	19.63
J63	2800802.931	38535271.035	27.60
J64	2800817.360	38535247.511	29.11
J65	2800830.184	38535221.380	18.64
J66	2800844.768	38535209.773	13.75
J67	2800854.555	38535200.114	37.50
J68	2800870.405	38535166.130	9.09
J69	2800877.319	38535160.228	26.69
J70	2800900.134	38535146.379	66.71
J71	2800960.886	38535118.820	14.62
J72	2800969.866	38535107.284	24.38
J73	2800964.149	38535083.579	18.33
J74	2800954.112	38535068.239	15.75
J75	2800941.676	38535058.570	21.49
J76	2800922.134	38535049.619	51.81
J77	2800886.957	38535011.587	

界址点坐标表

点号	X	Y	边长
J77	2800886.957	38535011.587	28.47
J78	2800913.940	38535002.519	26.88
J79	2800940.788	38535001.106	17.11
J80	2800945.358	38534984.613	16.04
J81	2800950.049	38534969.278	28.20
J82	2800952.826	38534941.212	22.05
J83	2800956.580	38534919.481	16.39
J84	2800960.921	38534903.678	12.24
J85	2800961.444	38534891.449	21.06
J86	2800962.492	38534892.233	26.21
J87	2800992.220	38534867.900	15.64
J88	2800979.048	38534859.460	9.38
J89	2800974.276	38534851.383	4.86
J90	2800975.230	38534846.622	16.89
J91	2800979.569	38534830.303	21.41
J92	2800988.473	38534810.829	9.30
J93	2800997.698	38534811.990	12.43
J94	2801009.766	38534814.972	18.17
J95	2801013.637	38534797.219	4.43
J96	2801013.257	38534792.805	2.54
J97	2801011.381	38534791.095	13.26
J98	2801018.386	38534779.832	13.12
J99	2801024.978	38534768.493	14.68
J100	2801039.156	38534772.309	5.33
J101	2801044.437	38534772.999	6.29
J102	2801050.703	38534772.473	8.80
J103	2801046.526	38534764.730	10.36
J104	2801049.372	38534754.770	3.38
J105	2801049.556	38534751.398	1.11
J106	2801049.317	38534750.310	14.47
J107	2801047.896	38534735.906	11.99
J108	2801058.262	38534741.934	31.96
J109	2801085.892	38534757.999	10.30
J110	2801092.426	38534765.956	2.25
J111	2801093.966	38534767.589	6.82
J112	2801098.474	38534772.713	3.79
J113	2801100.975	38534775.556	3.04
J114	2801103.008	38534777.822	12.21
J115	2801107.085	38534789.335	1.59
J116	2801107.618	38534790.838	4.10
J117	2801108.985	38534794.700	5.31
J118	2801110.575	38534799.763	2.85
J119	2801111.909	38534802.282	2.12
J120	2801113.177	38534803.977	3.29
J121	2801115.598	38534806.210	2.14
J122	2801117.190	38534807.643	0.56
J123	2801117.645	38534807.967	5.02
J124	2801121.712	38534810.912	2.64
J125	2801124.234	38534811.706	17.31
J126	2801141.067	38534815.762	12.95
J127	2801153.599	38534819.046	8.22
J128	2801161.737	38534820.196	1.62
J129	2801163.345	38534820.408	22.46
J1	2801185.280	38534825.248	

S=107976.76 平方米 合161.9651亩

2016年3月数字化制图。
1980坐标系
1985国家高程基准,等高距为1米。
1996年版图式。

1:2000

测量员:何远辉
绘图员:龚南浪
检查员:龚南浪